





TT MPTSTL INSTRUMENT SPECIFICATION



Please read the instrument instruction manual carefully before operating,
Avoid errors in the operation process



Catalogue



01 Product
Introduction

10 360° annular
Handle Introduce

02 System
Introduction

11 Model care

03 Multidimensional flat
Handle Characteristic

12 Circular nursing

04 360° annular
Handle Characteristic

13–18 Interface
Introduction

05 Instrument
dvantages

19 Instrument
Parameters

06 Matters needing
attention

20 Instrument
Maintenance

07 Instructions
for use

21 Configuration list

08 Screen
Introduction

22 Safety tips

09 Multidimensional flat
Handle Introduce

23 Notes



An instrument that does not cause wounds. The principle utilizes an ultra-micro pulsed ultrasound system to achieve a combination of point, line, and surface technology to achieve a full mode 360° perfect seamless full layer anti aging multi-layer lifting and tightening, precise, comfortable, fast, and durable effect. From now on, you can take care of your customers at your own home or in a beauty salon. Next, you will provide you or your customers with a beautiful nursing experience.

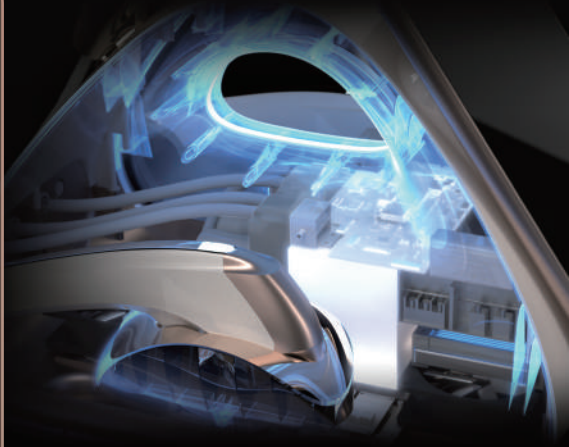
Will change your daily life and reshape your beautiful posture. Now you just need to follow the instructions in the guide.

01 Product Introduction

ULTRAMICRO PULSE ULTRASONIC SYSTEM

The instrument utilizes an ultra-micro pulsed ultrasonic system to switch the bidirectional instantaneous energy of the transverse linear acoustic pulse and the annular acoustic wave. The single machine realizes the combination of point, line, and surface technology, achieving a full mode of 360° perfect seamless, full-layer anti-aging, multi-layer lifting and tightening, with precise, comfortable, fast, and lasting effects.

In MP mode, the microsecond energy transmission mode has smaller and denser focus points than other instruments, higher security, comfortable experience, shorter recovery period, more uniform and more efficient point distribution.



02 System introduction



MICRO-PULSE OPERATION T ECHNOLOGY&PROBE

- MP mode (multi-point line formation) [417 points/1 engine in total]
- MP mode (point) [17 points/1 engine in total]
- Mechanical effect + thermal effect + cavitation effect
- Two-way output innovation technology
- Multiple probes with different depths of care
- Multi-mode combined nursing

03 Multidimensional flat Handle Characteristic

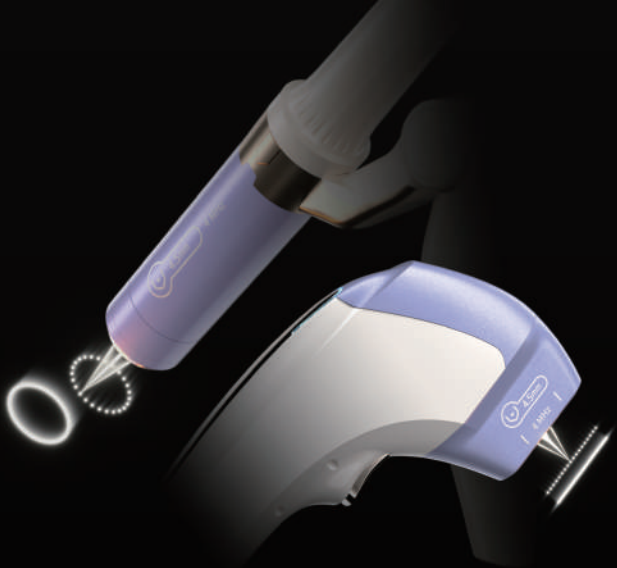
CIRCULAR OPERATION OPTIMIZATION HAND TOOL&PROBE

- MP mode (multi-point line formation)
[417 points/1 engine in total]
- MP mode (point) [17 points/1 engine in total]
- Innovative technology of micro transducer
- Endless operation of the ring
- Multiple probes with different depths of care
- Multi-mode combined nursing



Mechanical effect+ Thermal effect+ cavitation effect

The handle energy effect more accurately transmits energy to the target skin tissue layer, producing a thermal effect. Without damaging the surrounding tissues, it tightens the fascia, activates the regeneration of collagen and elastic fibers, achieving an anti aging effect of tightening and lifting, promoting collagen regeneration, and improving skin texture.



05 Instrument advantages

Precautions before and after operation :

1. Please read the "Instrument Description" carefully before operation to avoid errors in the operation process.
2. Before operation, keep the skin and hair clean. Do not make up before use, and try to clean the traces of the current makeup.
3. Before nursing, it is necessary to cooperate with the corresponding product gel lubrication to ensure the balance of energy during bilateral facial care.
4. It is normal to have temporary slight redness and swelling after instrument operation.
5. Pay attention not to go to high-temperature sauna, yoga and other high-temperature environment within 1 week after operation, and do not expose to the sun.
6. Do not wash your face with hot water within three days (water that does not exceed the body temperature is enough): pay attention to replenishing water, and it is recommended to apply the facial mask at least three times a week.
7. Don't eat anything with heavy color such as soy sauce, alcohol and spicy food within a week.

Unsuitable crowd or taboo :

1. A person who has implanted a pacemaker or other similar electronic device in his body.
2. Pregnant women.
3. People who have taken oral isotretinoic acid treatment in the past 9 months (Accutane/Roaccutane/Oratane).
4. There are fillings inside. If there is gold wire implantation on the face, it is not recommended.
5. Patients with serious heart disease, diabetes and hyperthyroidism.
6. The surgical wound is not healed.
7. Patients with advanced tumor.
8. Those who have unrealistic illusions about effects.

● Unpacking and inspection

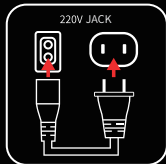
- Carefully take out the instrument and accessories from the packaging box, and keep the packaging materials for future transportation or storage.
- Check the accessories according to the list of accessories and check whether there is any mechanical damage.

● Instrument instructions



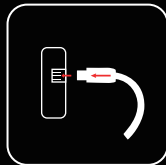
Installation screen

Align the card slot at the back of the screen with the instrument installation interface and push it down to the bottom.



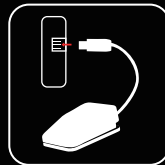
Startup operation

Connect the power cord and press the ON/OFF button on the back of the host.



connection handle

Align the handle cable plug with the interface and push it to the end. The three handles are not separated from the interface.



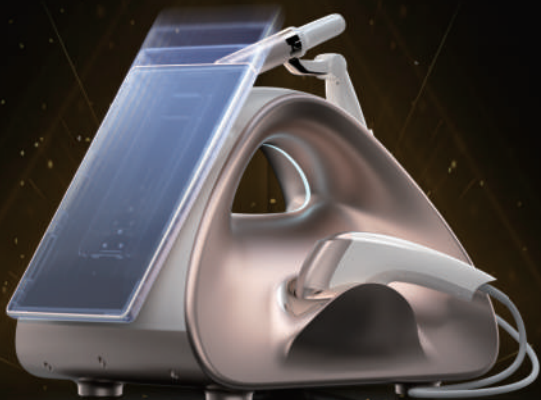
Connect the foot pedal

Align the pedal cable plug with the interface on the back of the instrument and push it to the end.

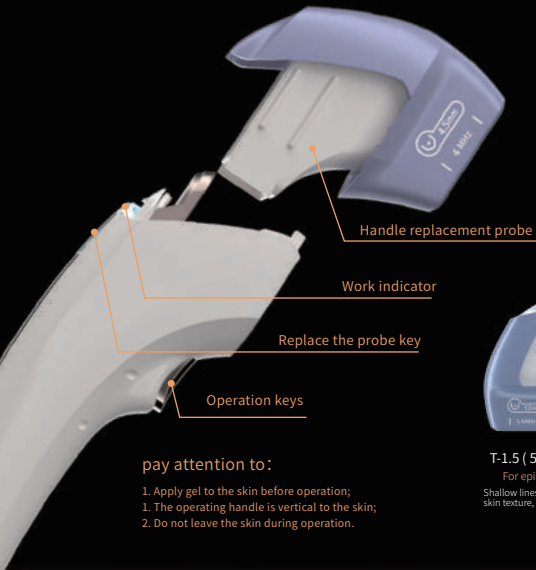
13.3

Inch HD smart screen

- Full dynamic design
- human-computer interaction
- Full sense of technology
- Removable plug
- Patented original design



08 Screen introduction



pay attention to:

1. Apply gel to the skin before operation;
1. The operating handle is vertical to the skin;
2. Do not leave the skin during operation.



T-6.0 (2Hz)

For epidermis
Skin color, skin texture,
pore shrinkage



T-9.0 (2Hz)

Direct to the dermis
Stimulate the
continuous proliferation
of collagen



T-13 (2Hz)

Direct to SMAS fascia layer
Tighten the bottom of
the muscle to achieve
a tight lift



T-1.5 (5.5MHz)

For epidermis
Shallow lines, skin color,
skin texture, shrink pores



T-2.0 (5.5MHz)

Original therapeutic head
For eye and deep wrinkles
such as forehead/neck/
crow's tail



T-3.0 (5.5MHz)

Direct to the dermis
Stimulate the
continuous proliferation
of collagen



T-3.0 (4MHz)

Direct to SMAS fascia layer
Tighten the bottom of
the muscle to achieve
a tight lift

09 Multidimensional flat Handle Introduce



T-1.5 (5.5MHz)

For epidermis

Shallow lines, skin color,
skin texture, shrink pores



T-3.0 (5.5MHz)

Direct to the dermis

Stimulate the
continuous proliferation
of collagen



T-4.5 (4MHz)

Direct to SMAS fascia layer

Tighten the bottom of
the muscle to achieve
a tight lift

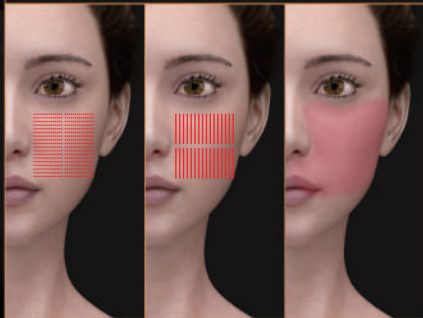


pay attention to:

1. Apply gel to the skin before operation;
1. The operating handle is vertical to the skin;
2. Do not leave the skin during operation.

10 360° annular Handle Introduce

Comparison of single-mode nursing

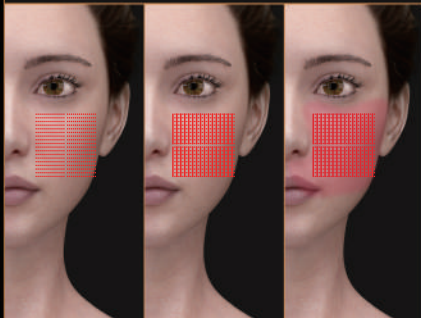


Dot pattern
(Flat hand tool)

MP model
(Flat hand tool)

Dot / MP mode
(Annular hand tool)

Multi-mode combined nursing



Dot pattern
(Flat hand tool)

Overlay
Dot mode+MP mode
(Flat hand tool)

Overlay
Dot mode+MP mode
(Flat hand tool +
Annular hand tool)

11 Model care

Circular operation optimization hand tool

The annular operating hand tool integrates the world's highest new technology ultrasonic energy output mode.

- Exquisite probe, exquisite and meticulous treatment.
- Fusion point mode&MP mode - endless output of ultrasonic energy in circular operation.

Annular running probe

The efficacy of the basic course of treatment, the addition of a new operating scheme, the consolidation of the effect and the expansion of the scope of application.



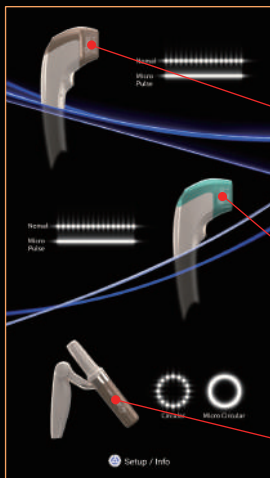


Figure 1 Selection Handle Interface



Multidimensional flat handle probe

Facial lift and skin firmness.
 Display the current handle with which probe handle.
 When the handle is lifted, it automatically switches the handle operation interface (Figure 2).



Multidimensional flat handle probe

Reshape the probe.
 Display the current handle with which probe handle.
 When the handle is lifted, it automatically switches the handle operation interface (Figure 2).



360 ° annular handle probe

Facial lift and skin firmness.
 Display the current handle with which probe handle.
 When the handle is lifted, it automatically switches the handle operation interface (Figure 3).

When you pick up the first handle, the instrument automatically recognizes and converts the corresponding handle probe operation interface. Whether you pick up another handle or two handles later, the instrument identifies and displays the operation interface for picking up the first handle. If you need to change the probe operation interface, first place all handles on the instrument, and then pick up the handle you need to operate. The interface automatically recognizes and converts the probe corresponding to the operation interface when you pick up the first handle.

The icon keeps rotating, indicating that the fan of the instrument is working properly.

Instrument internal temperature. Low Centre Tall

Note: If the internal temperature of the instrument is too high, it will automatically shut down and operate.

The current total number of rounds of the handle probe / the total number of rounds remaining in use.

Model and frequency of handle probe.

The energy adjustment size of the handle . (energy adjustment range: 0.1J - 3.0J)

STANDBY:
When the handle energy adjustment is ready, click Start.

READY:
After operating the handle probe, click Pause.

The number of shots used by all handles.
Note: The number of shots returned to zero after restarting.

The total length of the handle probe dotting, which can be selected by clicking. (Figure 6)

点击可切换探头打点模式.

Normal Dot pattern MP Linear mode

Click to select the parameter modes set on the three interfaces. (Figure 4)

Foot pedal operation. Operating with foot pedal

Handle key operation. Using the handle keys to operate.

Click to switch to the operation background interface of the adjustable instrument. (Figure 5)

The number of rounds currently used by the handle probe.

Energy animation during handle probe operation. (display corresponding dot mode animation)

..... Dot pattern ——— Linear mode

Note:
The multi-dimensional flat handle can be operated with a handle switch button, and some can be controlled with a foot pedal. The 360° annular handle is only operated by a foot pedal, and there is no handle switch button operation.

Adjust the total number of rounds required for instrument operation (maximum number 9999)
Total number of instruments used and operated / total number of instruments operated

Normal Dot pattern The interval length of the probe dots can be adjusted and selected by clicking. (Figure 7)

Click the icon to switch the dotting output direction.

Single Repeat 0.1s Unidirectional output. Bi-directional output. (cycle)

Repeat 0.1s Click 0.1 to switch to the interface for selecting cycle interval time. (Figure 8)

Figure 2 Multidimensional flat handle operation and adjustment interface

14 Interface Introduction



360° annular handle only operated by foot pedal (No handle switch key operation)

Foot pedal operation.

Operating with foot pedal

The 360° annular handle adjustment is the same as the multi-dimensional flat handle adjustment operation. (Figure 2)

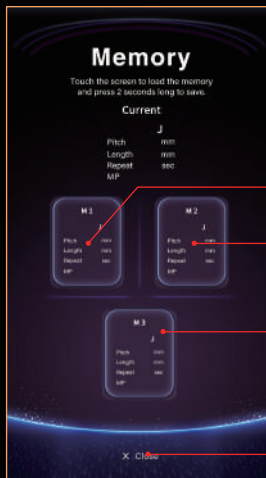
MP Linear mode

MP mode power only appears here

MP Linear mode

The default point interval length is -- mm

Figure 3 360° Annular Handle Operation and Adjustment Interface



Click "Enter" to select the parameter modes for three interface settings. Long press "Enter" to store all the settings for the currently entered interface.

Click to select the setting parameter mode of M1.

Click to select the setting parameter mode of M2.

Click to select the setting parameter mode of M3.

Return

Figure 4 Storage Mode Interface

15 Interface Introduction

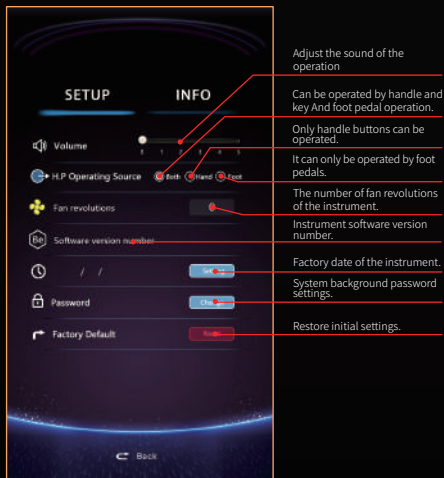


Figure 5 Instrument Operation Background Interface



Figure 5 Instrument Number Setting Interface

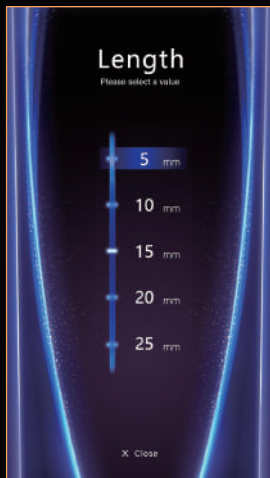


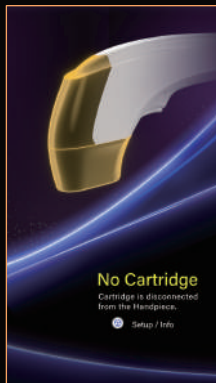
Figure 6 Total length of handle
probe dotting Click to select the length



Figure 7 Probe Dotting Interval
Length Click to Select Length

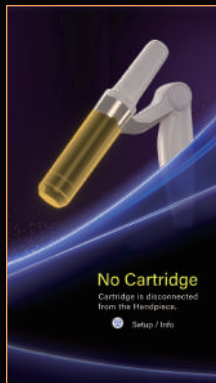


Figure 8 Number of probe taps
Cycle interval Click to select time



Multidimensional flat handle prompt interface

(The cable connector is not plugged in properly or the handle head is not plugged in properly)



360 ° annular handle prompt interface

(The cable connector is not plugged in properly or the handle head is not plugged in properly)



Pedal prompt interface

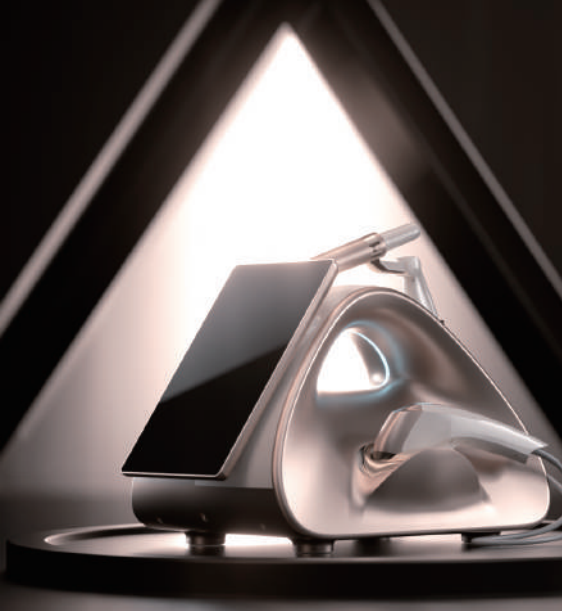
(The cable connector is not plugged in properly)



Instrument internal prompt interface

(Internal failure of the instrument)

18 Interface Introduction



Product Name : TT MPTSTL

Model : TT MPTSTL

Power Supply : AC 110V AC 220V

Power : 650W

Frequency : 2MHz 4MHz 5.5MHz

Instrument weight : 10kg

Gross product : 20kg
quantity

Package size : 60 X 43 X 57 cm

19 Instrument parameters

1. The instrument is a precision device. Before and after use, please pay attention to cleaning and maintenance to avoid damage or shorten the service life. After use, please turn off the instrument switch in time, cut off the power supply and pull out the power cord.
2. The instrument should be handled with care. Do not pull the handle wire head and the host output wire head forcefully to avoid loosening the internal connection of the accessories, causing poor contact, short circuit or electric leakage.
3. After the instrument and probe are used, do not throw them away at will. Clean them carefully with cleaning solution and clean cloth. It is recommended to clean the surface with normal saline or a little detergent.
4. Ensure that the power supply voltage is consistent and stable with the power supply voltage specified by the instrument. If the local power supply voltage is unstable, it is recommended to increase the power matching regulated power supply.
5. In order to improve the care effect of the instrument and ensure its normal service life, please use the accessories provided by the original manufacturer uniformly, or use the designated accessories recommended by the original manufacturer.
6. The instrument should not be too close to strong heat source or strong radiation source (disinfection cabinet, induction cooker, microwave oven, etc.), which will affect the normal use of the instrument.
7. It is not allowed to hit the instrument or collide with force. In case of failure, it can only be repaired by personnel with professional maintenance qualification approved by the original manufacturer.
8. It is not allowed to disassemble the inside of the instrument alone. When liquid or something enters the instrument and cannot be taken out by itself, it can only be carried out by the personnel with professional maintenance qualification specified by the original manufacturer.
9. The main machine and accessories of the instrument should be cleaned and cared regularly, and special attention should be paid not to let the liquid splash into the instrument or enter into the instrument.
10. The instrument should not be placed in damp places or near water sources, nor should it be directly exposed to the sun.



20 Instrument maintenance



Instrument



Hand shank



Hand shank



Hand shank



Handle head



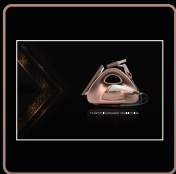
Handle head



Footrest



power cord



Instructions



Packing box

21 Configuration list

Professional tips:

Before use, please read the instructions carefully to use the instrument correctly.

This note is for the beautician to use this instrument safely and correctly, in case of emergency.

In order to indicate the size and extent of the hazard or damage, the incorrect use in this notice is divided into warning and caution.

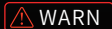
This manual is specially marked with illustrations and icons. Its representative meanings are as follows:

In order for you to operate the instrument in a standard way:

- After understanding the meaning of the logo, please read this manual.
- After reading, please store this manual in a place where you can find it at any time.
- As the following contents are closely related to safety issues, please strictly comply with them.



Possible death or serious injury



Possible injury or damage to the instrument



The sign indicates that there will be danger, warning and caution, and the specific prompt content is recorded in the icon. (The left figure is applicable to no specific and general danger, warning and notice).



The mark indicates that there are prohibited behaviors, and the specific prompt contents are recorded in the icon and below the icon. (The left figure is applicable to no specific and general prohibition notices).



A mark indicates that there is an action that needs to be enforced or instructed, and the specific content of the enforcement or instruction is recorded in the icon. (The left figure is applicable to no specific general compulsion or instruction)



Pay attention

Precautions for use

- Understand and master the correct use of the instrument before operating the instrument.
- Cooperate with the company's designated skin care products for instrument care.
- Please take care step by step according to the conclusion of the customer's skin test and the degree of skin needs. When the customer's skin and physique reach the tolerance limit, please adjust the mode in time.
- Please confirm that the electrical specifications of all parts of the instrument are in good condition before use.
- In case of sudden power failure during operation, the power supply must be cut off in time to prevent the instrument from being burnt out by sudden power.
- After the nursing, make sure to cut off all power supplies related to the instrument.

Pay attention

- When installing the instrument, please be careful not to drop the instrument during loading and unloading.